



TELUS Optik TV[®]

Self-Install Guide

Table of Contents

Before you get started Page 1

Step 1: Setting up your wireless access point..... Page 2

Step 2: Setting up your wireless digital box..... Page 3

What you'll find in your kit:



1x Wireless access point

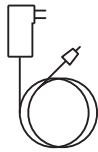

2x Power supplies

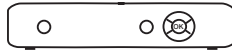

1x Wireless digital box



1x Optik TV remote



2x AAA batteries



1x HDMI cable



1x Ethernet cable

Additional support:

If you need help during installation, TELUS technical support representatives are available 24/7.

Please call **310-MYTV (6988)** for assistance or visit [telus.com/selfinstall](https://www.telus.com/selfinstall) for additional information.



We are continually listening to our customers to make your experience better every day. Amazing service, it's what sets us apart.

Before you get started

Confirm your TV has an available HDMI input:

Your kit includes an HDMI cable to connect your wireless digital box to your TV. If your TV doesn't have an HDMI input, you can use component audio and visual cables instead. Visit [telus.com/selfinstall](https://www.telus.com/selfinstall) for details.

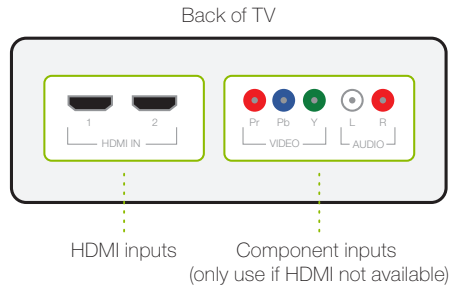

Identify your TELUS Internet modem:

You will already have a modem installed in your home. Your wireless access point (included in the kit) will connect to your modem using the Ethernet cable provided.

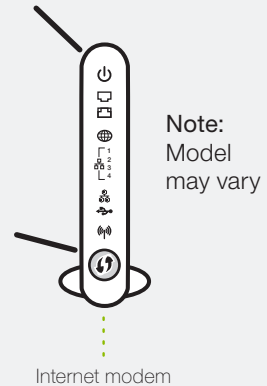

Step 1: Setting up your wireless access point

1a

Connect the power supply for the wireless access point.

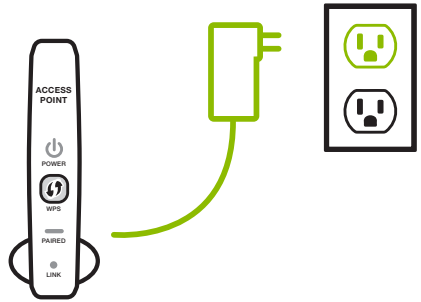

1b

Use the Ethernet cable to connect the wireless access point to an available yellow LAN input on the back of your modem.

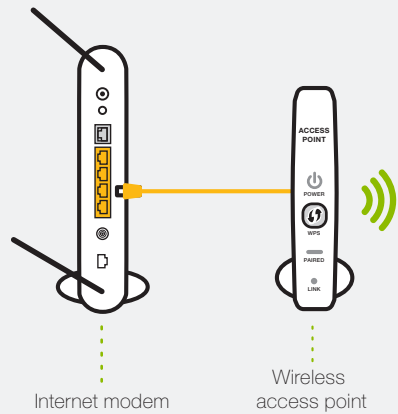

1c

Confirm that the switch on the back of the wireless access point is in the AP position.

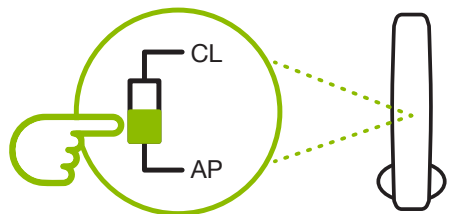

Step 2: Setting up your wireless digital box

- 2a Connect the power supply for the wireless digital box.

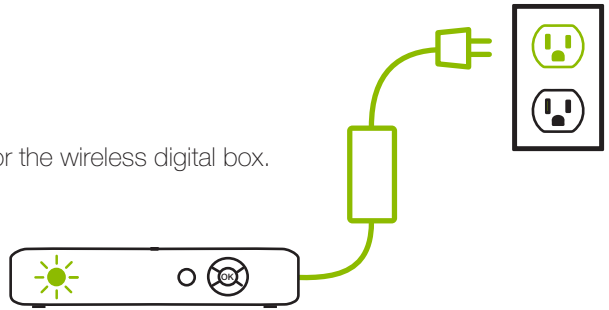

- 2b Using the HDMI cable included in your kit, connect the wireless digital box to any available HDMI input on your TV.

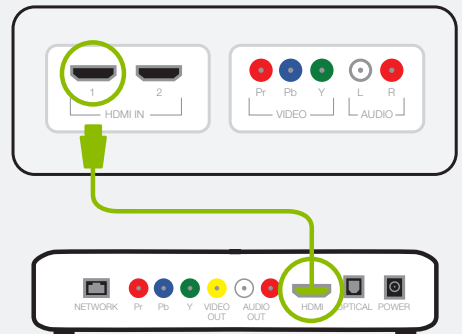

- 2c Using your TV manufacturer's remote, turn on your TV and use the input/source button to select the input used for the wireless digital box.



2d

A screen will appear indicating that pairing was successful (it may take a few minutes). You are now ready to watch TV.

For additional support and troubleshooting, visit telus.com/selfinstall.

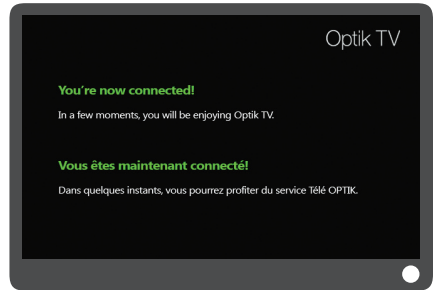

2e

Insert the batteries into the remote to control the wireless digital box. If you wish to pair this remote with your TV as well, please visit telus.com/programremote.

